



Issue Date: January 22, 2004

SB Number: SB0018B

**Topic:** Premature rear bearing failure due to excessive vibration

**Application:** Medic Master HD ambulance, Cummins ISB engine with extended mounting link for alternator, CEN C510 alternator

Inspect all installations that fit above criteria. Remove extension link and re-mount alternator:

1. Disconnect master switch.



Electric shock hazard. Can cause severe injury or death. Disconnect master switch before servicing.

2. Loosen bottom mounting hardware on alternator.
3. Remove extension link connecting alternator to engine bracket. Discard link. See Figure 1.
4. Remove engine bracket. Enlarge top engine mounting hole to 15/32". See Figure 2. Re-install engine bracket. Install 13/32"x1-1/4"x.047" (10.5mmx 30mmx2.5mm) large OD zinc-plated steel washer and existing bolt at top hole only. Use existing hardware for lower hole. Refer to engine manufacturer's specifications for proper hardware. Do not tighten mounting hardware.



Make sure electric radiator fan wire brace is reinstalled properly.

5. Swing alternator up and align top mounting hole in alternator with mounting hole in engine bracket.

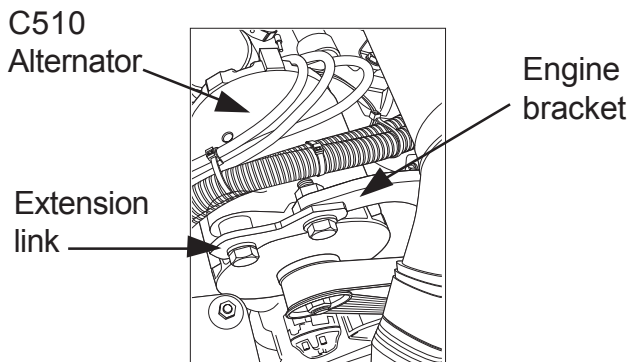

Figure 1 Extension Link removal

Install, but do not tighten, mounting hardware—use 1-1/2" long bolt and lockwasher.

6. Torque hardware on engine mounting holes in engine bracket per engine manufacturer's recommendation. Apply Loctite® 242 thread lock or equivalent on bolts.
7. Torque alternator bottom mounting bolts to 88 Nm/ 65 lb. ft.
8. If gap between alternator mounting bracket and engine bracket is wider than 1/8", insert washers or other suitable shim. Then torque top mounting bolt to 88 Nm/65 lb. ft.
9. All vehicles equipped with C510 alternators should be inspected for possible corrosion on regulator harness connector terminals.
  - **If NO corrosion is found:**
    - a. Seal any open connector wire cavities with non-corrosive (non-acidic) Silicone/RTV sealant.
    - b. Allow sealant to cure. Re-install connector.
    - c. Check charging system operation.
  - **If corrosion is found:**
    - a. Replace components as needed. Contact CEN to obtain replacement components.
    - b. Check charging system operation.

\*LOCTITE IS A REGISTERED TRADEMARK OF LOCKTITE CORPORATION

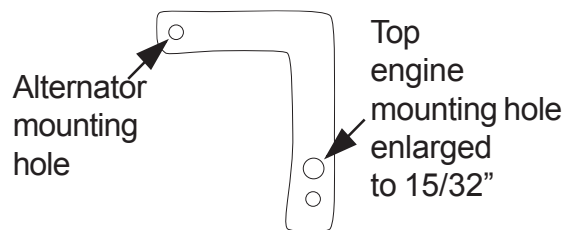

Figure 2 Engine Bracket Installation

**Please file this CEN Service Bulletin with your CEN Literature.  
Please forward a copy of this information to the appropriate people in your company.**